

C-EXPLORER SG

Dental Ultrasonic Surgical Device

Piezo, Implant, Surgery

10% 
Upgraded power

80 N (20:1)
High-Torque

300-44000 rpm
Wide speed range

3 in 1



COXO[®]

Professional Dental Manufacturer
SINCE 2003

C-EXPLORER SG

Dental Ultrasonic Surgical Device

Precision Ultrasonic Cutting.
Multi-Mode. Versatile.

Intuitive Touch Control.
Wireless Foot Pedal. Total Freedom.

Customized Implant Workflow.
High Torque. Clear Visibility.

Quick Water Switch.
Precise Flow Control & Flexible Use.

Multi-Procedure Platform.
Preset Programs. Stable & Efficient.

Powerful Output.
High Speed & Reliable Performance.

Smart Maintenance System
Auto-Cleaning, Built to Last.

Multi-Device Compatible.
Versatile for Any Scenario.



C-EXPLORER SG

Dental Ultrasonic Surgical Device

COXO[®]

Professional Dental Manufacturer

SINCE 2003

Implant Function

Fully customizable implant program,
tailored to clinician workflow.

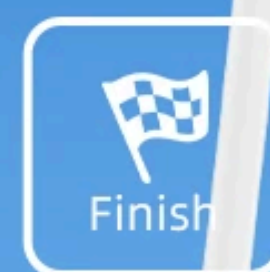

Customizable



C-EXPLORER SG

Dental Ultrasonic Surgical Device

COXO[®]

Professional Dental Manufacturer

SINCE 2003

Ultrasonic: Smart & Powerful

Bone Surgery | Periodontal | Endodontic
Covers most surgical needs

3 LED Lighting
Modes

Versatile Compatibility
Works with multiple tips

One-touch
15% power increase.

Auto Bone Density Matching
7 levels for all bone types

7 Water Settings | 20-100ml
Versatile for All Uses



C-EXPLORER SG

Dental Ultrasonic Surgical Device

COXO[®]

Professional Dental Manufacturer

SINCE 2003

Precision Meets Efficiency

Pre-set surgical programs
streamline every procedure – from extraction to bone shaping.



•Extraction

Preset programs for
atraumatic extraction.



•Apical resection

Optimized speed
settings for precise
resection.



•Sinus Lift

Safe and reliable
settings for
sinus floor elevation.



•Saw handpiece

High-efficiency modes
for reciprocating, agittal,
and oscillating saws.

10 adjustable ratios.

Endless clinical possibilities.



C-EXPLORER SG

Dental Ultrasonic Surgical Device

COXO[®]

Professional Dental Manufacturer
SINCE 2003

Small Size · Big Power

Ultra-low heat motor
with high output in a compact body



 **Maximum
Implant Torque**

Up to 80N·cm (with 20:1 contra angle)

Torque

N·cm

 **Wide speed
range**

Up to 44000 rpm

300

44000

Speed

rpm

+

-

C-EXPLORER SG

Dental Ultrasonic Surgical Device

COXO[®]

Professional Dental Manufacturer
SINCE 2003

Wireless Multi-Function Pedal

Seamless wireless control
Fast, stable, and precise



Coolant control

Mode selection

Power control

Operation

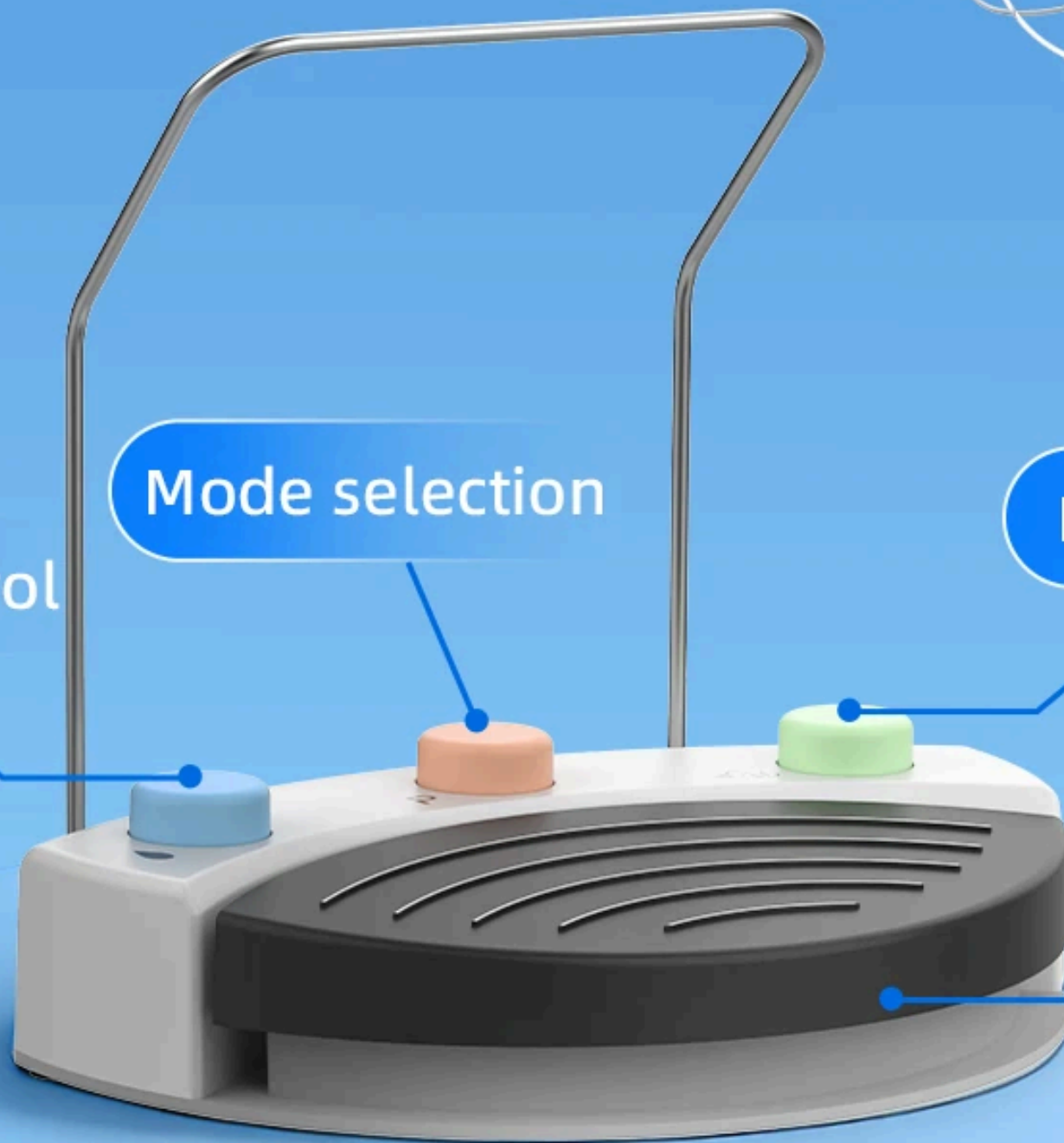

C-EXPLORER SG

Dental Ultrasonic Surgical Device

COXO[®]

Professional Dental Manufacturer
SINCE 2003

One-Touch Cleaning

Effectively removes residue to extend device lifespan.



3 Modes

Piezo Function

Supports bone surgery, periodontal treatment, and root canal therapy



Implant Function

Self-changing steps, multi-speed ratio adaptation



Surgery Function

Pre-programmed settings for common procedures, meeting daily needs



Maintenance Guide

Intelligent maintenance guide to help extend the device's lifespan

